



CAPSUJET
capsule conveying

Capsule Conveying Systems



Proven
Capsule Transfer
Technology

hanningfield





CAPSUJET
capsule conveying

The Most Reliable System For Safe Capsule Transfer

The **CapsuJet** is one of Hanningfield's most innovative and popular products. Originally invented and patented by Hanningfield in 1995, the **CapsuJet** is the ideal answer to the capsule conveying needs of global industry leaders.



Why Choose CapsuJet?

The success of the **CapsuJet** lies in a simple design which is able to produce remarkable results time after time. Transfer rates of 100% have ensured the **CapsuJet** remains the best and most comprehensive solution for hard-shell capsule conveying applications.

Features	Benefits
Excellent current GMP/Polished stainless steel	For sanitary processing environments
Gentle conveying	Capsules transferred without damage
100% of capsules transferred every time	No Waste
Level sensor easily fitted to filling machine to control flow of capsules	Overfill protection
Can be loaded away from filling machine avoiding fibre shedding materials in clean area	Improves sanitary environments
	Allows installation in any room
Transfer tubing supplied to suit installation	Can convey all capsule sizes using one machine
No change parts between capsule sizes	Safe operation
Very quiet operation	Low operating costs
Maintenance free	Low power consumption
Requires only single phase electrical supply	No ladders/catwalks for increased safety
Low filling height	No need to repeatedly load the capsule filler hopper
Large receiving hopper on C20 (Empty Capsule Conveyor)	For use with all hard shell capsule types and sizes
Versatile design	Keeps pace with high speed capsule filling machines
High transfer rate	

How It Works

The **CapsuJet** has been designed and built to overcome the problems associated with conventional equipment used for the automatic loading or emptying of capsule filling machines. The **CapsuJet** uses a gentle, low velocity airstream which is generated by a fan or blower, ensuring all capsules are successfully conveyed without damage.

“LOAD IT AND LEAVE IT”

The **CapsuJet** will automatically keep pace with capsule filling machines, ensuring it remains supplied with empty capsules.

1. Entire boxes of capsules are fed with ease into a large diameter, low height infeed hopper, providing increased efficiency and operator safety.
2. A tangentially discharged airflow from a multi-stage fan or blower consistently transfers 100% of capsules at high rate without damage.
3. The airflow then transfers the capsules into the capsule filling machine.

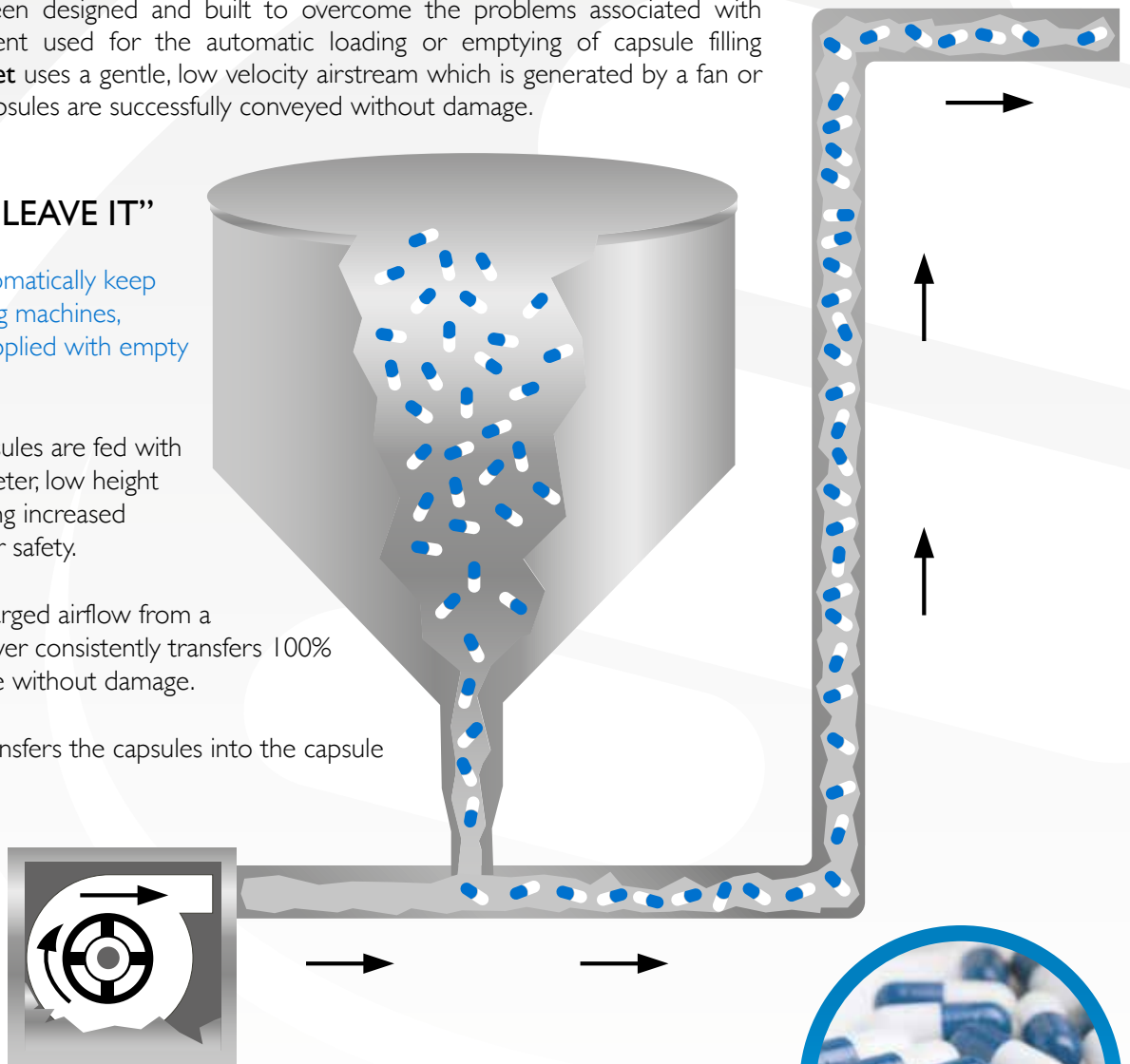

Design Options

All Hanningfield systems are designed with the client's needs in mind. Consequently, we can cater for any requirements. All products come with full documentation, such as IQ/OQ or mill certificates.

- HEPA filtration
- Customized Hoppers
- Easy connect elbows
- Passivated contact surfaces
- Rigid or anti-static conveying lines
- Ceiling mounting brackets for conveying lines



CAPSUJET

capsule conveying

Technical Specifications

Transporting Empty Capsules To The Filling Machine

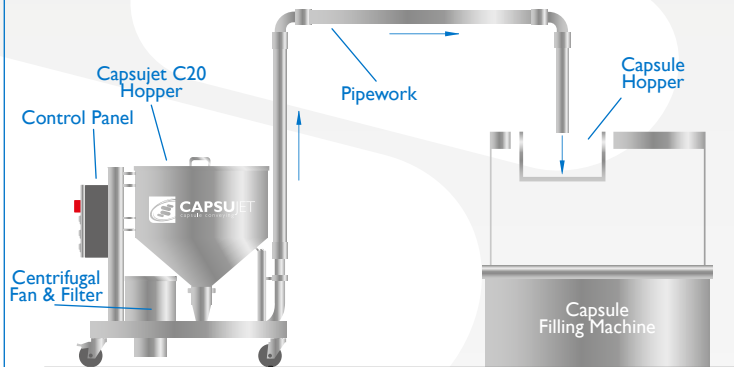

Empty capsules are fed into the C20 hopper straight from shipping cartons.

The capsules are then blown through a 50mm conveying pipeline to the capsule hopper on the capsule filling machine.

A level sensor which is mounted to the capsule filling machine controls the on/off flow of capsules.

Transporting Filled Capsules After The Filling Machine

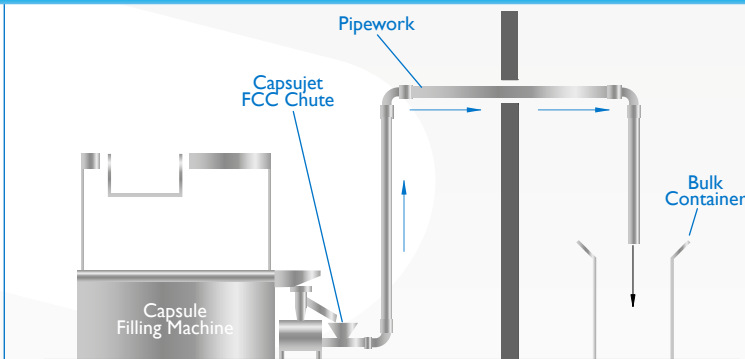

Filled capsules drop into the FCC chute from the capsule filling machine.

These capsules are then immediately conveyed away on a cushion of air through anti-static pipe work to the packaging area.

Technical Data

*Based on tests with size '3' Posilok Capsules, and sizes #5-0 Capsugel Capsules

Model	C20 (Empty Capsules)	FCC (Filled Capsules)
Transfer Rate (Capsules Per Hour)	*300,000	*200,000
Maximum Conveying Distance	Horizontal > 10m (33')	Horizontal > 5m (16.5')
	Vertical > 5m (16.5')	Vertical > 2.5m (8.25')
Standard Hopper Size	200L (100,000 Size "0" Capsules)	No Hopper
Dimensions	1100mm x 800mm x 1105mm	1000mm x 450mm x 316mm

Contact Details:

UK and Worldwide (Headquarters):

Hanningfield Process Systems Ltd
17 Millhead Way, Rochford, Essex, SS4 1LB, United Kingdom
T: +44 (0) 1702 549 777
E: info@hanningfield.com

USA, Canada and Puerto Rico:

Hanningfield (North America)
PO Box 1178, Hillsborough, North Carolina, 27278, USA
T: +1 (919) 338 2884
E: northamerica@hanningfield.com

Australasia and South East Asia:

Hanningfield (Pacific)
PO Box 362, Kenmore, Qld 4069, Australia
T: +61 (0) 488 242 158
E: pacific@hanningfield.com